



CARDI
Belysning från Elektroskandia

FLOW SYSTEM



EN60598/CEM2001/108/CE

230V 50Hz
IK08 IP20
-20°C/+50°C
Energiklass E

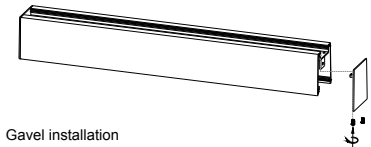

Gavel installation

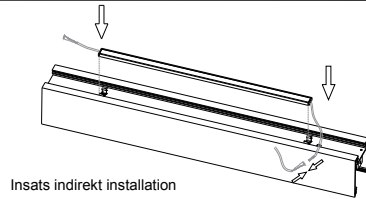

Insats indirekt installation

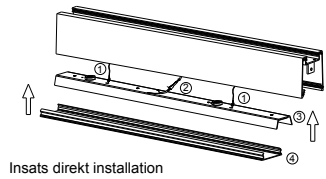

Insats direkt installation

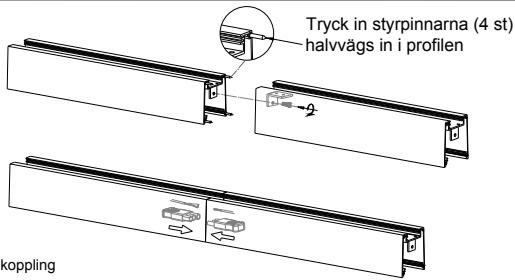

Profilkoppling

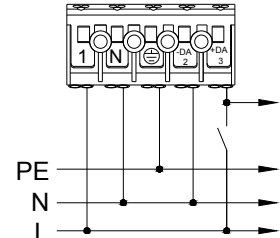
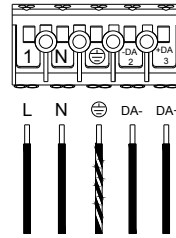

OBS! Vid användande av indirekt ljusinsats så ska mA-inställningen på drivern ändras enligt etikett i armaturen och enligt detta schema.

Armatur	lout	1	2	3	4	5	6	DIP Switch
1175mm	Direkt/Indirekt HO 800mA	●	●	●	○	●	●	
	Direkt/Indirekt LO 400mA	●	○	●	○	○	○	
1775mm	Direkt/Indirekt HO 1200mA	●	●	○	○	○	○	
	Direkt/Indirekt LO 600mA	●	○	●	○	○	○	
2375mm	Direkt/Indirekt HO 1600mA	●	●	●	○	○	●	
	Direkt/Indirekt LO 800mA	●	●	●	○	●	●	

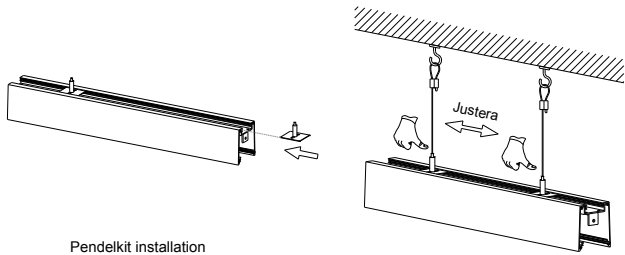

Pendelkit installation

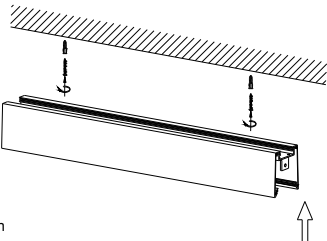

Tak installation

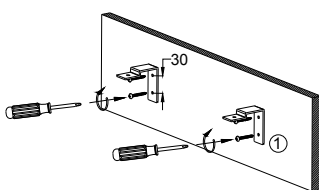
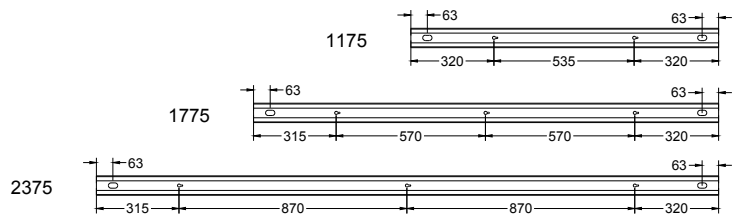

Vägg installation

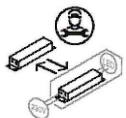
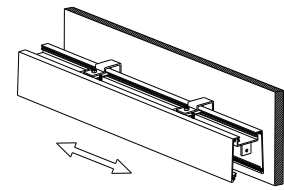
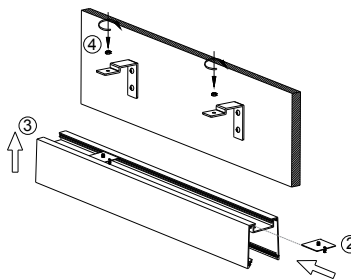

Drivdonet i denna armatur får endast bytas av tillverkaren eller av tillverkaren utsedd kvalificerad personal.

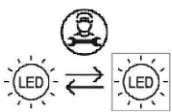

* Armaturen innehåller löstagbar LED-modul som har energiklass E.

Ljuskällan i denna armatur får endast bytas av tillverkaren eller av tillverkaren utsedd kvalificerad personal.





CARDI
Belysning från Elektroskandia

FLOW SYSTEM INFÄLLD



EN60598/CEM2001/108/CE

230V 50Hz
IK08 IP20
-20°C/+50°C
Energiklass E

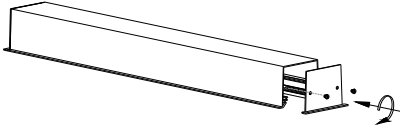

Gavel installation

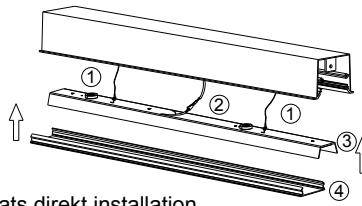

Insats direkt installation

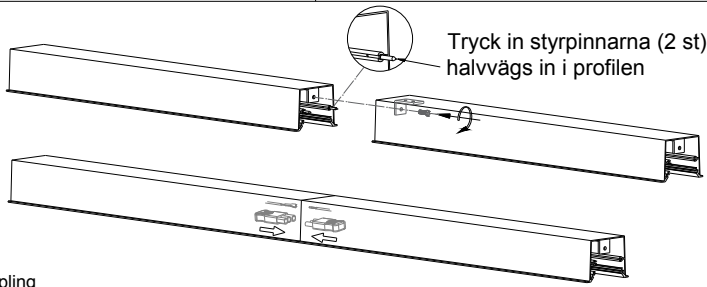
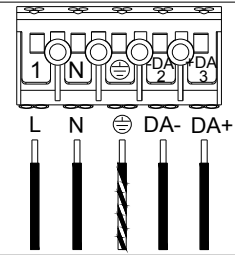

Profilkoppling

Tryck in styrpinnarna (2 st) halvvägs in i profilen

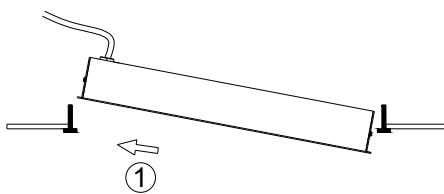
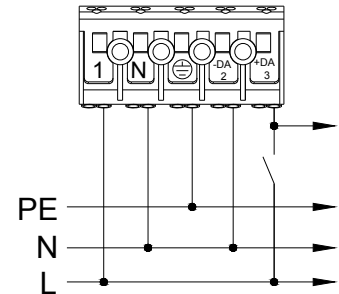

Infälld installation 1

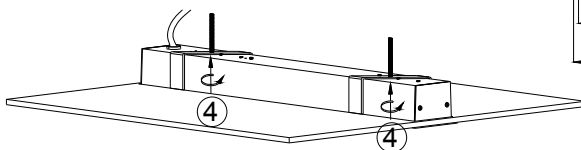
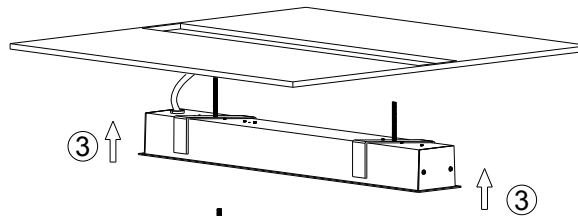
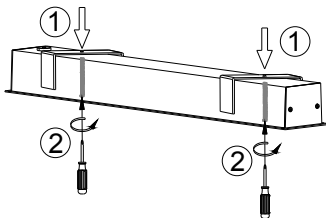
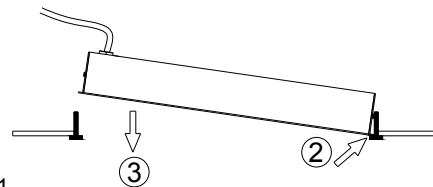

Infälld installation 2

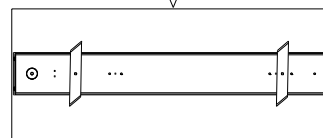
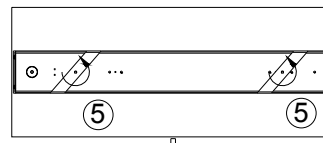
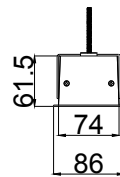

Håltagningsmått

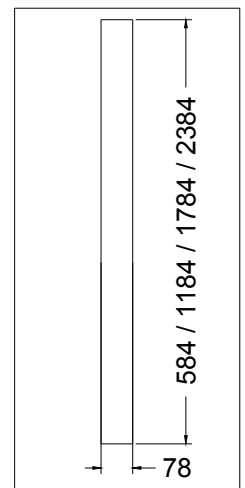

Drivdonet i denna armatur får endast bytas av tillverkaren eller av tillverkaren utsedd kvalificerad personal.

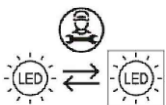

* Armaturen innehåller löstagbar LED-modul som har energiklass E.

Ljuskällan i denna armatur får endast bytas av tillverkaren eller av tillverkaren utsedd kvalificerad personal.



www.cardi.se
Elektroskandia Sverige, 191 83 Sollentuna



CARDI
Belysning från Elektroskandia